

Multi-grip vices 80 – 160 spare parts

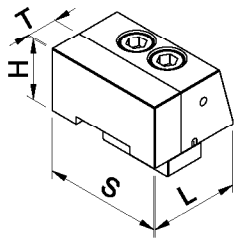

Ganascia fissa 80 lavorabile
completa di viti e tassello
per tipo "D" - "E"
Personalizzabile su quote S L H T
cod. : J 94 056 P

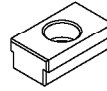

Linguetta per cave a T
Riduzione 14 - 12
cod. : J 94 016 R14

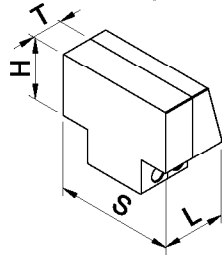

Ganascia mobile 80 lavorabile
completa di sist. bloccaggio
per tipo "D"
Personalizzabile su quote S L H T
cod. : J 94 057 P

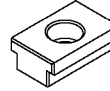

Linguetta per cave a T
Riduzione 16 - 12
cod. : J 94 016 R16

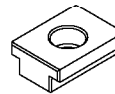

Linguetta per cave a T
Riduzione 18 - 12
cod. : J 94 016 R18

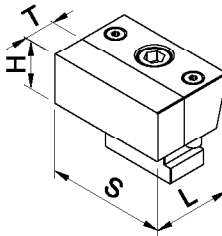

Ganascia discendente 80 lavorabile
completa di viti e tassello
per tipo "E"
Personalizzabile su quote S L H T
cod. : J 94 058 P



Ganascia di bloccaggio laterale
per viti M12
cod. : J 94 040 M12

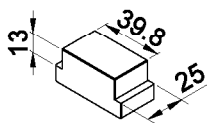

Tassello senza foro
per Ganascia discendente 80
e Cuneo 80
cod. : J 94 013 P

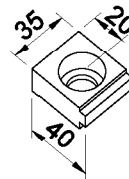

Ganascia di bloccaggio laterale
per viti M16
cod. : J 94 040 M16

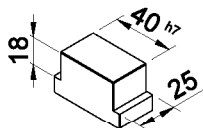

Tassello senza fori
per Ganascia fissa 80
cod. : J 94 014 P

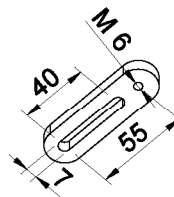

Piastrina per riferimento
laterale morse
cod. : J 94 041

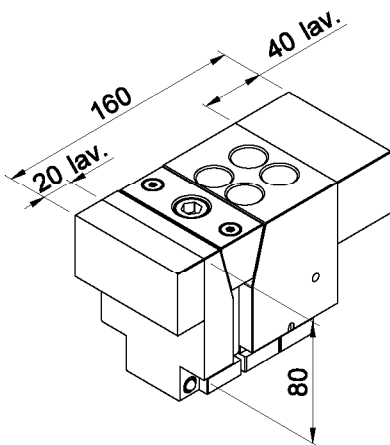

Gruppo di spinta aggiuntivo 80 lavorabile H80
completa di viti e tasselli
per tipo "D" speciale H80
cod. : J 80 001 D H80