

Multi-grip vices 80 – 160 spare parts

MORSE MULTIPRESA
MULTI-GRIP VICES

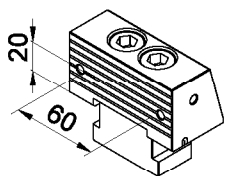

Ganascia fissa 80
completa di viti e tassello
per tipo "A" - "B" - "C"
cod. : J 94 051

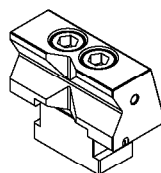

Ganascia fissa 80 a "V" per
tondi
completa di viti e tassello
per tipo "F"
cod. : J 94 059

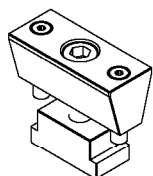

Cuneo 80
completo di viti e tassello
per tipo "A" - "C"
cod. : J 94 052

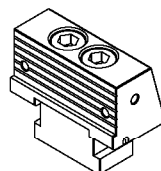

Ganascia fissa 80 con scalini
completa di viti e tassello
per tipo "G"
cod. : J 94 060

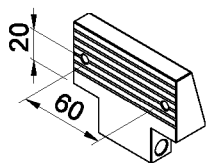

Ganascia mobile 80
completa di sist. bloccaggio
per tipo "A" - "C" - "F"
cod. : J 94 053

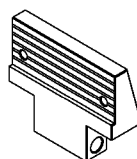

Ganascia mobile 80 con scalini
completa di sist. bloccaggio
per tipo "G"
cod. : J 94 061

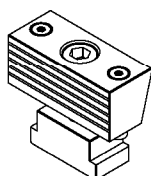

Ganascia discendente 80
completa di viti e tassello
per tipo "B"
cod. : J 94 054

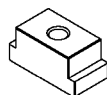

Tassello 1 foro
per Ganascia discendente 80
e Cuneo 80
cod. : J 94 013

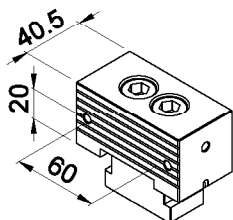

Ganascia fissa 80 parallela
completa di viti e tassello
per tipo "C"
cod. : J 94 055

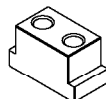

Tassello 2 fori
per Ganascia fissa 80
cod. : J 94 014

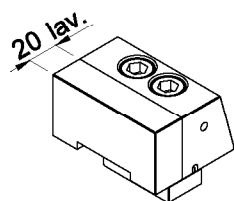

Ganascia fissa 80
lavorabile
completa di viti e tassello
per tipo "D" - "E"
cod. : J 94 056

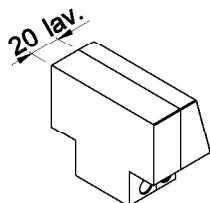

Ganascia mobile 80 lavorabile
completa di sist. bloccaggio
per tipo "D"
cod. : J 94 057

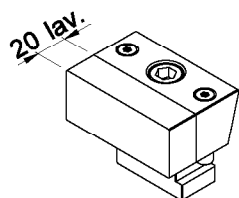

Ganascia discendente 80
lavorabile
completa di viti e tassello
per tipo "E"
cod. : J 94 058